



EDMUND G. BROWN JR.
GOVERNOR



MATTHEW RODRIGUEZ
SECRETARY FOR
ENVIRONMENTAL PROTECTION

State Water Resources Control Board

**NOTICE OF TEMPORARY INSTREAM FLOW DEDICATION AND TEMPORARY CHANGE ORDER
FOR PERMIT 21198 (APPLICATION A031055) OF
CAMP MEEKER RECREATION AND PARK DISTRICT**

COUNTY: Sonoma

STREAM SYSTEM: Russian River

On August 28, 2015, Camp Meeker Recreation and Park District (Petitioner) filed a temporary urgency change petition and an instream flow dedication petition with the State Water Resources Control Board (State Water Board), Division of Water Rights (Division) requesting approval of a temporary change to water right Permit 21198 (Application A031055) pursuant to Chapters 6.6 and 10 of Part 2 of Division 2 of the Water Code. On September 3, 2015, the Division conditionally approved the petitions and issued an Order allowing Petitioner to temporarily dedicate water for instream beneficial uses in Dutch Bill Creek and augment flows to support survival of state and federally endangered coho salmon (*Oncorhynchus kisutch*) and federally threatened steelhead (*Oncorhynchus mykiss*) during the 2015 drought. The instream flow dedication will continue up to the first substantial rain event or until flow conditions in Dutch Bill Creek recover to a minimum of 0.1 cfs, but not after December 31, 2015.

Summary of Permit 21198 and Petition for Change:

Source:	Russian River Underflow tributary to the Pacific Ocean
Point of Diversion:	Monte Rio offset well at NW ¼ of SE ¼ of Section 7, T7N, R10W, MDB&M
Season of Diversion:	January 1 to December 31 of each year
Amount of Water:	Existing: 0.23 cubic feet per second (cfs) by direct diversion not to exceed 90 acre-feet per annum (afa) Proposed: 0.23 cfs by direct diversion not to exceed 90 afa. Up to 30 acre-feet (of the 90 afa) at a maximum rate of up to 0.2 cfs, will be dedicated for instream beneficial use in Dutch Bill Creek
Purpose of Use:	Existing: Municipal and Fire Protection Proposed: Addition of Fish and Wildlife Preservation and Enhancement
Place of Use:	Existing: Within the boundaries of Camp Meeker as shown on map filed with the State Water Board, being within portions of Sections 21, 22, 27, and 28, T7N, R10W, MDB&M Proposed: Addition of a reach of Dutch Bill Creek to the place of use. The upstream limit is located at North 1,921,868 feet and East 6,282,809 feet by California Coordinate System 1983, Zone 2, being within NE ¼ of SW ¼ of Section 21, Township 7N, Range 10W, MDB&M. The downstream limit is located at the confluence of Dutch Bill Creek and the Russian River at North 1,932,731 feet and East 6,272,591 feet within NE ¼ of the SW ¼ of Section 7, Township 7N, Range 10W, MDB&M

FELICIA MARCUS, CHAIR | THOMAS HOWARD, EXECUTIVE DIRECTOR

1001 I Street, Sacramento, CA 95814 | Mailing Address: P.O. Box 100, Sacramento, CA 95812-0100 | www.waterboards.ca.gov

More information regarding the temporary urgency change petition and instream flow dedication petition and the Order approving the changes can be viewed at:

http://www.waterboards.ca.gov/waterrights/water_issues/programs/applications/transfers_tu_notices/index.shtml

Pursuant to Water Code section 1438, subdivision (d), any interested person may file an objection to the temporary changes. The procedure for addressing an objection is described in Water Code section 1438. Objections filed in response to this notice should be submitted to the persons listed below and must be received by the Division by 4:30 p.m. on **October 9, 2015**.

Send objections to both:

Sarah Sugar
Permitting Section
Division of Water Rights
P.O. Box 2000
Sacramento, CA 95812
Sarah.Sugar@waterboards.ca.gov

Gary Helfrich
Camp Meeker Recreation & Park District
P.O. Box 461
Camp Meeker, CA 95812
gary@bikesonoma.org

For more information regarding this project, including procedures for filing objections, please contact Sarah Sugar at (916) 341-5426 or Sarah.Sugar@waterboards.ca.gov. Written correspondence or inquiries should be addressed as follows: State Water Resources Control Board, Division of Water Rights, Attn: Sarah Sugar, P.O. Box 2000, Sacramento, CA 95812-2000.

DATE OF NOTICE: September 9, 2015

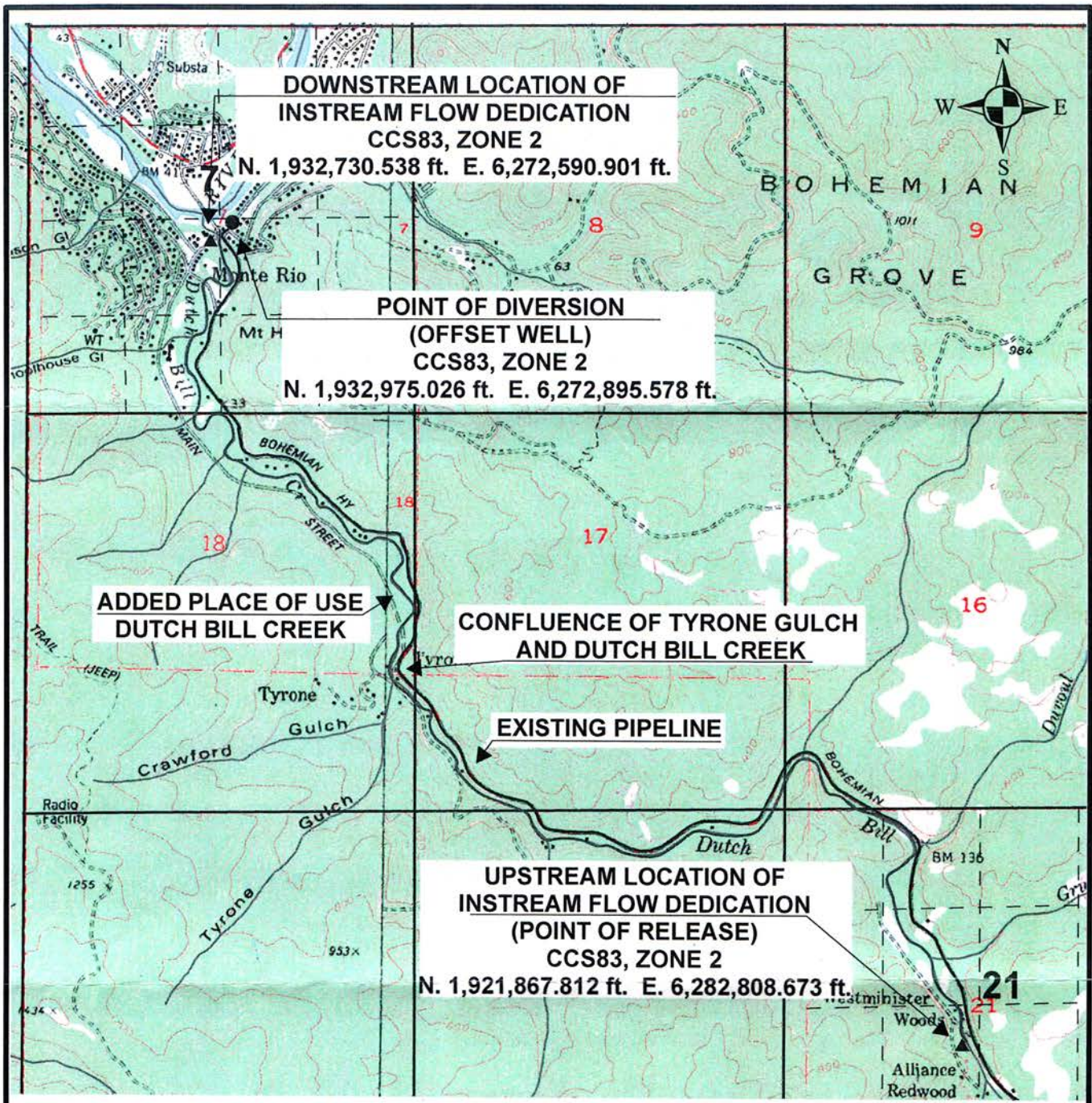

OWNER CAMP MEEKER RECREATION AND PARK DISTRICT

SOURCE (POD 1) RUSSIAN RIVER

POINT OF DIVERSION

WITHIN NW 1/4 OF SE 1/4 OF PROJECTED

SECTION 7, T7N, R10W, MDB&M

COUNTY OF SONOMA

U.S.G.S. QUAD: **DUNCAN MILLS** DATE: PH. RE. 1981 SCALE: 1:25,000

STATE OF CALIFORNIA
CALIFORNIA ENVIRONMENTAL PROTECTION AGENCY
STATE WATER RESOURCES CONTROL BOARD
DIVISION OF WATER RIGHTS

APPLICATION NO. 31055

PERMIT NO. 21198

URGENCY CHANGE

DATE: 9-2-2015 DRAWN: SHS CHECKED:

Note: This map does not constitute a public land survey as defined by California Business & Professions Code section 8726. It has been prepared for descriptive purposes only.